

Halloween 5km

Stafford VA
Measured by Vic Culp
On Oct 28, 2018

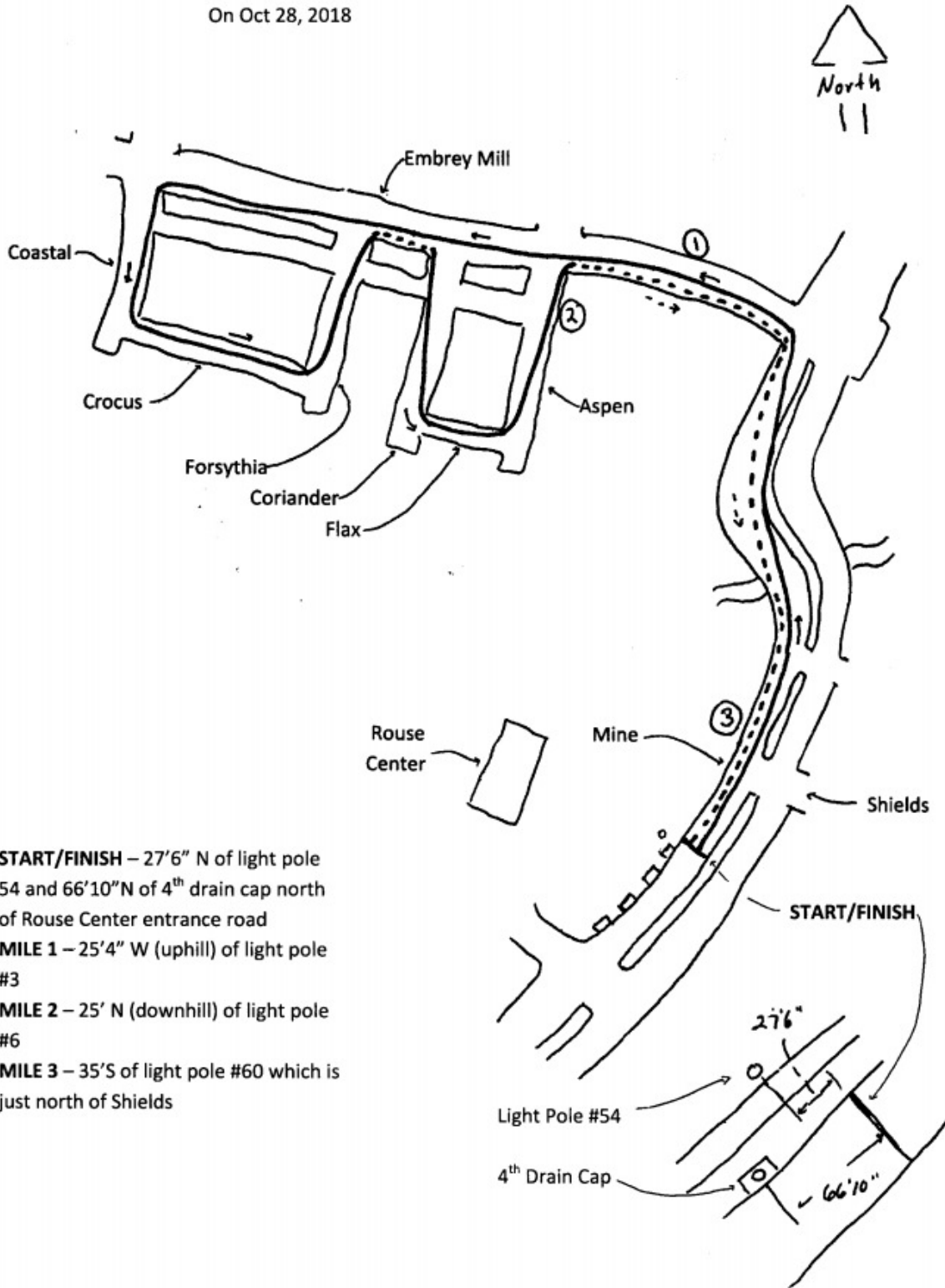

START/FINISH – 27'6" N of light pole 54 and 66'10" N of 4th drain cap north of Rouse Center entrance road
MILE 1 – 25'4" W (uphill) of light pole #3
MILE 2 – 25' N (downhill) of light pole #6
MILE 3 – 35'S of light pole #60 which is just north of Shields